

THIS DRAWING IS AN UNCONTROLLED COPY UNLESS STAMPED OTHERWISE

CONTRACTORS SHALL VERIFY JOB DIMENSIONS BEFORE ANY JOB COMMENCES. ALL SHOP DRAWINGS SHALL BE SUBMITTED TO THE SUPERINTENDENT AND MANUFACTURER SHALL NOT COMMENCE PRIOR TO THE RETURN OF AWARDED SHOP DRAWINGS. BY THE CONSULTANT, DIMENSIONS SHALL TAKE PRECEDENCE OVER SCALES. THIS DRAWING SHALL BE READ IN CONJUNCTION WITH ALL RELEVANT CONTRACT SPECIFICATIONS AND DRAWINGS COPYRIGHT OF THIS DRAWING IS VESTED IN BUNDA.

General Notes

- Rw 35** [AWT-01] [AWT-02]
 - Rw 40** [AWT-03]
 - Rw 45** [AWT-04]
 - Rw 50** [AWT-05] [AWT-06]
 - Rw 55** [AWT-07] [AWT-08]
 - Rw 60** [AWT-09]
- REFER TO AECOM SCHEDULE OF ACOUSTIC PARTITION TYPES

Acoustic Transfers - Refer to AR610 & AR611 for Acoustic Transfer Bulkhead / Duct Locations
 - Refer to Aecom, U.L.A. Mechanical Engineer Specification & Drawings for Requirements

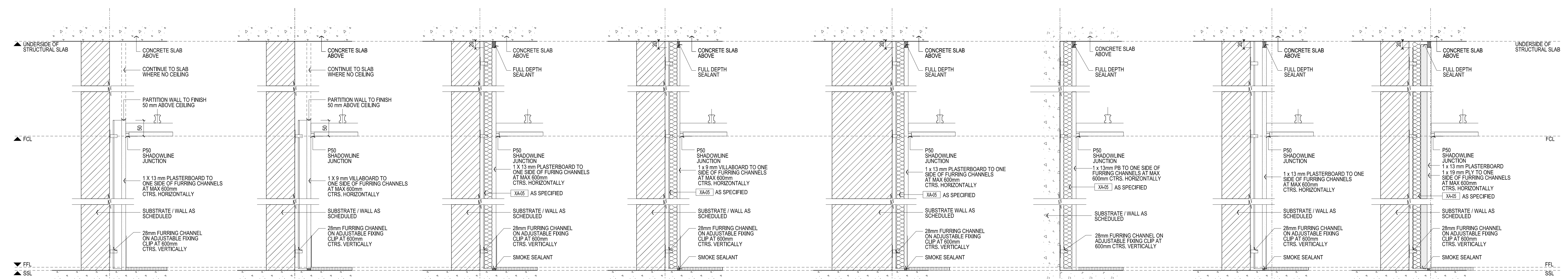
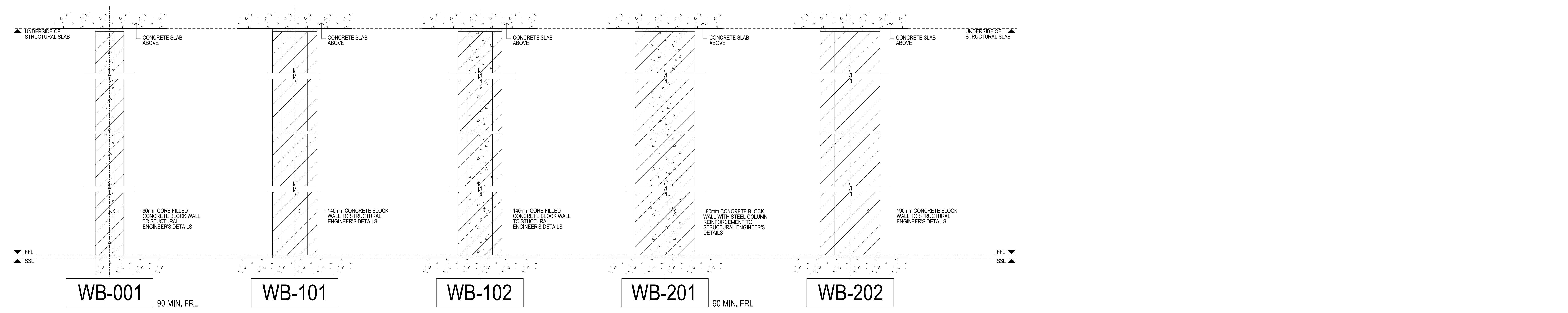

D	SG	WALL TYPE ADDED	-	20.11.13
C	SG	UPDATES AS CLOUDED	-	18.09.13
B	SG	UPDATES AS CLOUDED	-	17.09.13
A	SG	UPDATES TO INCLUDE ACOUSTIC REVISIONS	-	20.08.13
09	SG	VALUE MANAGEMENT ISSUE	-	28.03.13
08	SG	100% CD - TENDER ISSUE	-	07.09.12
07	SG	90% CD ISSUE	-	10.08.12
06	SG	75% CD ISSUE	-	13.07.12
05	SG	50% CD ISSUE	-	01.06.12
04	SG	FINAL CD ISSUE	-	24.02.12
PARTITION TYPES ADDED				
03	SG	DO UPDATE	-	27.01.12
02	SG	DO UPDATE	-	20.01.12
01	SG	DESIGN DEVELOPMENT	-	22.12.11
Rev	Issue	Revision Description	Amd	Date



NADAAA
 NADAAA
 1920 Washington Street No.2
 Boston Massachusetts 02118 USA
 Telephone +1 817 442 8232
 Facsimile +1 888 442 1417
 Email nadaa@nadaa.com

John Wardle Architects
 25 Rokeby Street, Collingwood, Victoria 3066 Australia
 Tel: +61 3 8662 0400 www.johnwardlearchitects.com
 © 2012 John Wardle Architects ABN 83 006 814 268

Client **University of Melbourne Parkville Campus**
 Project **Faculty of Architecture Building and Planning**

Title **WALL TYPE DETAILS SHEET 1**

Project No.	0913	Scale	1:5 @ A0 1:10 @ A2
Drawing No.	AR7500	Revision	D

Date: Dec 2011 Drawn: Co-Ord: Chk:

FILENAME - \$FILES

FOR CONSTRUCTION

